

TECLINE

NEW PRODUCTS/2016

THE PERFECT
CONFIGURATION

POWER JET FINS

PEANUT 21 ASYMMETRIC

SIDE 16 AVENGER

US-40 LED LIGHT



TECHNICAL
DIVING EQUIPMENT
CATALOGUE

NEW FINS FOR TECHNICAL CAVE & WRECK DIVERS

TECLINE POWER-JET



**„EXCELLENT MANOEUVERING CHARACTERISTICS:
EFFECTIVE FOR LONG DISTANCE SWIMMING
USING MODIFIED TECHNIQUE.”**

WOJTEK A.FILIP

Wreck diver and cave diver: GUE, IANTD, PADI, CMAS instructor.
Technical diving equipment designer. Inventor of Tecline POWERJET fins.

- ① EASY AND PRECISE MANOEUVERABILITY
- ② IDEAL FOR MODIFIED FLUTTER AND FROG KICKS
- ③ FIT STANDARD BOOTS, FLEX/TURBO SOLES AND ROCK BOOTS PERFECTLY
- ④ SAVE ENERGY AND REDUCE GAS CONSUMPTION

THREE OPTIONS OF HARDNESS TO CHOOSE FROM:

SOFT: for beginners

(a great alternative to any soft fins plus all the benefits of a jet fin)

MEDIUM: the standard choice

(ideal for cave, wreck and dives over a long distance)

HARD: for demanding users*

(e.g. photographers, survey divers, instructors)

***WARNING!** YOU NEED TO BE GENUINELY FIT TO SELECT THIS OPTION!



HOW ARE TECLINE POWERJET FINS DIFFERENT?

WHAT HAVE WE CHANGED?



The MEDIUM and SOFT versions of our fins are best for swimming for long distances using modified techniques to reduce the diver's effort while maintaining a constant pace.

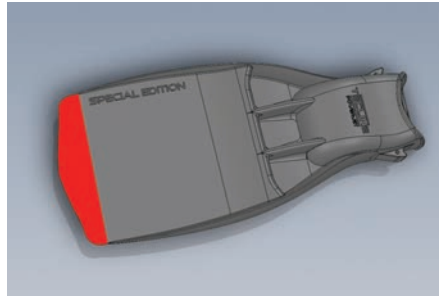

The longer blade helps make modified flutter and frog kicks more effective.

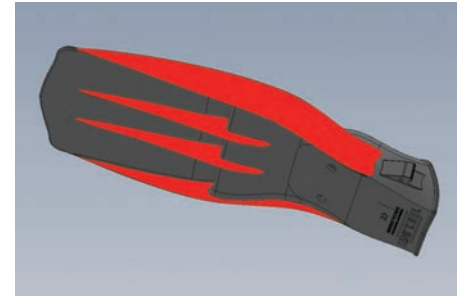

Higher edges and additional stabilizing ribs along the blade make it easier to swim backwards. They also limit the need for a frog kick to be "closed" and thus minimize the risk of silting caused by water movement.



The much greater angle of the blade allows the diver to swim close to a silty bottom while under a low ceiling and, again, reduces the need for a frog-kick to be closed to create forward propulsion.

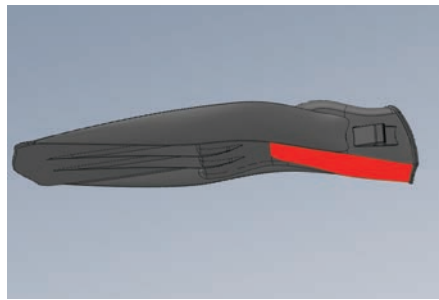

The modified angle of the bottom of the foot-pocket allows a diver to descend narrow shafts, move down a slope easily and quickly change trim by lifting the fin blades with a foot movement similar to what you do when you accelerate while driving.

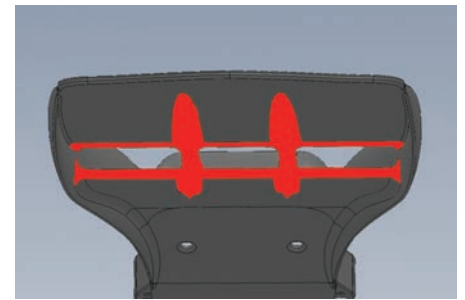

Much larger water vents allow greater stability and prevent the fins "rocking" when the diver swims faster. The vents also mean that less power, and therefore energy, is required when a diver swims slowly.



The fins' composition, using 2 different types of rubber of various hardness, and the rigid stabilizers act like a spring assisting propulsion, reducing diver effort, gas consumption and CO2 build-up.

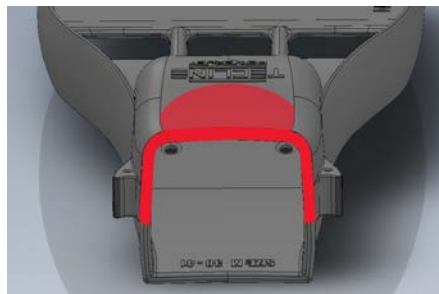

The use of a softer rubber for the sole of the foot pocket makes the fins more comfortable for divers with a high instep and those diving in classic rubber boots. It also reduces the chance of a diver slipping on a wet dive deck.



The spring fitting is attached to the fin above the heel. This means that it acts to hold the diver's foot in the pocket from the side as well as from the rear. This stops the foot moving from side to side and keeps the diver more stable.

TECLINE PEANUT 21

ASYMMETRIC



A SMALL WING WITH THE LARGEST POTENTIAL ON THE MARKET!

PEANUT 21 ASYMMETRIC WILL SURPRISE YOU IN AT LEAST **4 WAYS:**

1. A VERY DIFFERENT LOOK – THE WORLD'S FIRST ASYMMETRIC WING

2. DOUBLE DURABILITY – TWO EXTREMELY DURABLE LAYERS:

EXTERNAL LAYER IS 1000D CORDURA, INTERNAL IS PU240

3. EASY BUOYANCY CONTROL

AND THE LARGEST CAPACITY IN ITS CLASS – 21 LITRES

4. ULTRA LIGHT – ONLY 950g!

**TECLINE PEANUT 21
ASYMMETRIC,
A SERIES OF WINGS WITH
EXCEPTIONAL FEATURES:**

- easy buoyancy control
- large 21 liter capacity
- weighs only 950g (**less than 1 kg!**)
- extreme durability guaranteed by 1000D Cordura
- 3D construction
- plenty of head space
- permits a variety of hose configurations
- large capacity means even excellent surface support, even for heavy equipment
- asymmetric shape allows for fast deflation in an emergency
- combines perfectly with the V2 ICE Mono regulator

The innovative design of the **PEANUT 21** series allows free head movement and easy hose placement in a variety of configurations.



Is having the perfect equipment configuration important to you?
If you are a diver using a single cylinder, choose a Peanut 21 wing and a V2 ICE Mono regulator.



V2 ICE MONO + PEANUT 21
=
THE PERFECT CONFIGURATION

3 EDITIONS OF PEANUT 21

CE CERTIFIED CE1463 EN1809



LADIES SET

TOTAL WEIGHT ONLY **4 KG**

BE A WOMAN UNDER WATER AS WELL!

The Ladies Edition Peanut 21, with its distinctive purple highlights, is specially designed for women. Softer, adjustable shoulder straps cut away from the torso for greater comfort. The use of 1000D Cordura for the wing ensures exceptional durability.

- perfectly suited to the female figure
- easy buoyancy control
- small in size, light in weight but large in capacity (21 litres)
- lightweight aluminum backplate and aluminum mono tank adapter
- easy to use weight pockets



ARCTIC SET

TOTAL WEIGHT ONLY **4.95 KG**

THE ADVENTURE STARTS RIGHT HERE!

Wreck diving? Or maybe a dive under ice? You need equipment that you can trust unconditionally. When you slip into your Arctic Edition PEANUT 21, with its distinctive blue highlights, it feels just right! Comfortable, the inflator right where it should be and easy buoyancy control to enable you to deal with all conditions.

Use two V2 ICE Mono regulators in a SEMI TECH configuration tested in the toughest conditions especially for divers just like you.

- 21 liter capacity
- fully adjustable harness with stainless steel d-rings
- polished stainless steel backplate made of acid resistant steel
- stainless steel mono tank adapter with 2 single cylinder bands and strong clips
- easy buoyancy control
- keeps the diver high in the water on the surface
- strong 1000D Cordura



TRAVEL SET

TOTAL WEIGHT ONLY **2.95 KG**

ARE YOU A TRAVELLER? AIRLINE BAGGAGE WEIGHT LIMITS ARE NO LONGER A PROBLEM!

Take the Travel Edition Peanut 21 with you and don't worry about airline baggage weight limits. It's very durable but very light.

- lightweight construction
- no unnecessary features
- ultra-light backplate with no need for a mono tank adapter
- two single tank bands
- 21 liter capacity

SIDE 16 AVENGER PERFECT FOR BOTH

THE RECREATIONAL DIVERS AND Hardcore CAVE DIVERS

CE CERTIFIED CE1463 EN1809



**CLEAN, DIR-STYLE
HARNESS**



**SIDEMOUNT DIVING MADE EASY:
SIMPLE AND CLEAN.**

KAREL & MICHAËL – AVENGER DESIGNERS

- Easy to configure and adjust
- Harness shoulder straps or waist belt can be separately adjusted
- Straight forward adjustments make this an ideal set-up for teaching
- Integrated wing and harness
- 16kg lift capacity
- Add up to 19kg of weights
- Extra weight pockets available in 2 sizes (2kg and 4.5kg)
- 4 integrated weight pockets (10kg in total), putting the bulk of the weight in the ideal position on the diver's back. These pockets are positioned lower and slightly outwards, allowing a more streamlined profile and better trim
- The weight pockets on the waist belt also help dry suit divers maintain perfect trim by positioning the extra weight towards the lower part of the body
- Rear dump valve in a strategic and protected position on the lower side of the wing, to make it easy to release gas when the diver is horizontal or upside down
- Low profile bladder to reduce drag and lower the risk of getting stuck in restrictions
- Inflator can be placed on either the left or right side
- Detachable beavertail to attach heavier steel cylinders or accessories

SIDE16 AVENGER

... sidemount diving made easy, clean and simple ...

TECLINE

TECLINE LED LIGHTS

US-40 SIDE MOUNT



US-40



TECHNICAL SPECIFICATIONS:

- Light source: CREE LED XM L2,4 PCS
- Color temperature :6000K to 7000K
- Beam Angle: 15 °
- Output brightness :4000 Lumens
- Batteries: Lithium ion battery pack
- Run time:
(100%)120 minutes
(50%) 240 minutes
(15%) 800 minutes
- Dimensions :
head ø 65.5x97mm
canister ø 51x190mm
cable length 1150mm
- Weight (without battery) 1.5KG
- Operation temperature
+40 ° C~50 ° C
- Bulb life: 50,000 hours



TECLINE SIDE 16



PHOTO FROM TECLINE BELGIUM



TECHNICAL SPECIFICATIONS:

- Buoyancy: 16 kg/35 lbs
- Integrated weight pockets and external weight pockets on the waist belt
- Max. weight pocket capacity: 16 kg
- Aluminum back plate
- Adjustable waist and chest belt
- Adjustable crotch strap
- 5 D-Rings (stainless steel)
- Quick release valve
- K-type inflator (33 cm/13")
- Inflator can be mounted left or right
- Integrated shoulder pads
- Material: Cordura 2000
- Ready to use with all hardware and bungees needed

EQUIPMENT TEST

TECLINE SIDE 16

BY

**DOMINIK "KESSER"
KESSELRING**



PADI OWSI / PADI SIDEMOUNT INSTRUKTOR / EFR INSTRUKTOR

WWW.NURKOWANIEREKREACYJNE.PL

By courtesy of Tecline, last weekend I tested the new edition of Tecline Side 16 harness for a side mount. It is another edition of this product. Tecline clearly listens to the market and quite rapidly adapts to its needs. Given that the side mount is a relatively fresh branch of recreational diving, responding to needs that arise in the "battle" is essential here. It should be noted that Tecline has a lot to offer in the Sidemount category. In addition to several harnesses there are also regulators, torches and accessories dedicated for side mount. It is worth mentioning that there are two variants of the Side 16 Avenger harness on offer with one piece of band, including one coated with kevlar. The harness that we tested is the Side 16 with harness Comfort, well known from Tecline wings.

Tecline thus solved the main problem of instructors and course participants on side mount courses with a long process of harness configuration and customization for the course participants.

FIRST IMPRESSIONS

The BCD and harness offer a solid and compact construction. Everything looks well thought out and suited. The first benefit is that the letters are embroidered so are rather tough (in a harness from another manufacturer there are some letters missing because they were wiped out after a year of diving).

The BCD itself is triangular with permanently fixed, relatively wide butt-plate. All this creates a "turtle shell", streamlined design that best highlights on the loins. It is covered from the outside by a rough Cordura, which is quite pleasant to the touch and feels very durable. In this version an additional dump valve is mounted on the back of the neck, with a typical red ball in the left shoulder strap, well known on the jacket. This solution can be worrying about hooking up underwater etc. The manufacturer, however, in this way wanted to facilitate the change into the side mount. On the other hand a blind plug is included in the set, thanks to which we can eliminate the valve and enjoy a fully pro bag. In my opinion, the idea hits the jackpot and honestly speaking people diving recreationally will simply appreciate having this valve, and the purists have a plug :-).



EQUIPMENT TEST

The crotch strap passes through the butt-plate. It is equipped with a folding d-ring. The butt-plate merits attention, because since the beginning of the Side, quite massive rings divided into three parts are mounted to it. I think that this is a better solution than one long piece of wire. This allows for easier management of equipment and easiness in operating the carabiners. It is worth mentioning about the bungee mounting system. Tecline has abandoned a single bungee mounted on the carabiners which I think is a good strategy.

The manufacturer has chosen a loop system, which is fixed to the d-ring of the chest with bungee rails. On the one hand there is no d-ring, on the other there are supporters of mounting on the hook on the grounds that they will easily find the bungees. Anyway, it is impossible to make everyone happy and there are over a dozen systems guiding the bungees, so it is difficult to consider this matter in terms of pluses and minuses.

The BCD is equipped with a standard inflator known from other Tecline products. In summary, the harness makes a very good impression. Tecline produces tested structures, so there is no doubt that this is also robust and durable.

CONFIGURATION AND FIT

I still remember my side - mount course and 3 hours lost on adjusting the harness. And still after classes at the pool you had to adjust the whole equipment to the dry suit. The Side 16 setting was actually reduced to adjusting the waist belt. The shoulder straps are adjusted as in the jacket. In my case, the bungee seemed ideally suited.

From my experience of diving with aluminum tanks I know I have to put the weights as low as possible to compensate for the displacement of the bottom of the tank. It turned out that the 2kg weights fit ideally on the crotch belt under the butt - plate. Important information for the aesthetes - it is mounted on the inside, so it's not visible from the outside.

So, the initial setup took a moment and the harness was ready for use. It is also worth saying more about the weight system. The BCD has 4 solid pockets inside, which can easily accommodate 16 or even 20 kg of weight. There is a small zippered pocket that can accommodate 1 kg of ballast in the upper part of the neck, and car keys, etc. ideal for trimming. Additionally, 2x5kg weight pockets have been assembled on the belt, which in my opinion are not necessary for 2 x 11.1l alu set. As you can see, the Side 16 configuration does not differ from the configuration of a jacket. Hence, this is a great solution for instructors, course participants and all those who appreciate comfort, especially travelling and diving in the dry suit and wet suit in exchange.

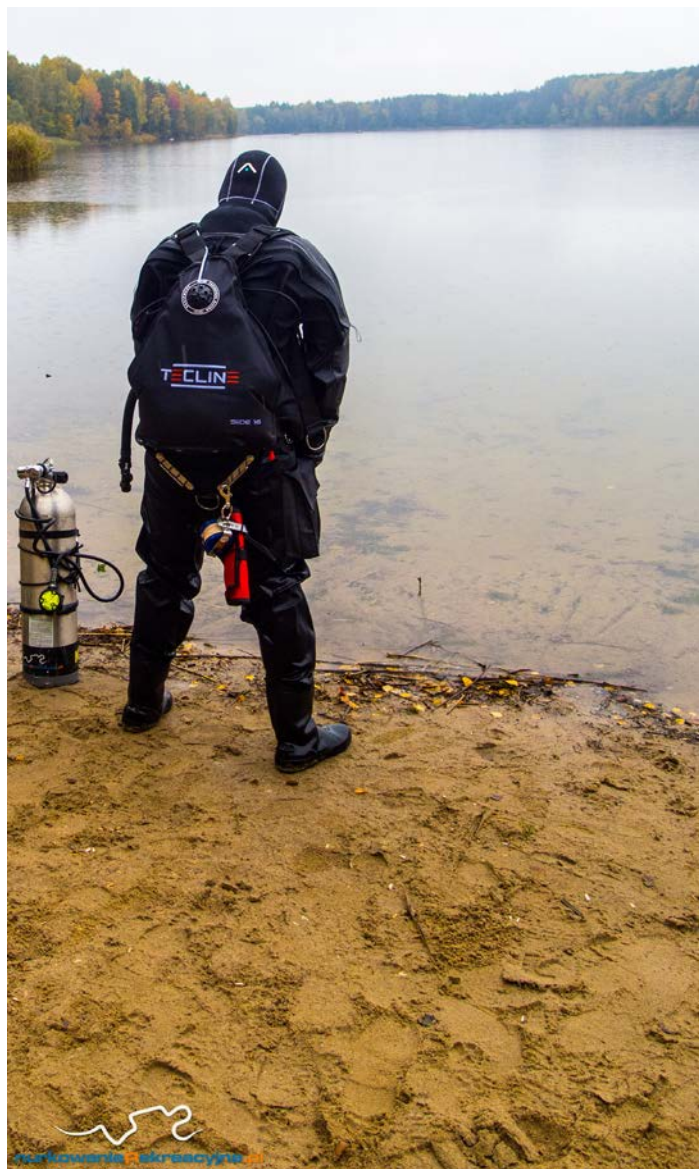

GOING UNDER WATER

Putting on the harness was something.

Immediately after putting it on and fastening the belt, I got the impression that the harness was clinging to my back. My approach was a little skeptical about the issue of the adjustable harness that it would not loosen under the weight. Nothing like this happened.

Throughout the dive the harness was in place. Attaching the tanks did not cause any problems. The rubber guiding system was also a success. The BCD worked flawlessly in the water. I immediately got used to this additional dump valve and I must admit that it was simply convenient. As mentioned, the gear was stable throughout the dive and there was no change in the body position, rotation, swimming sideways or upside down and unfastening the tank did not cause any changes. I had the impression that the harness was glued to my back. Immediately after immersing, I felt that the harness with the butt-plate formed a rigid structure and enforced the proper position under the water, which should be considered as an advantage. In the upper part, the harness does not restrict movement, and thanks to the easy adjustment system it allows you to make corrections and adjustments during the dive. The moving d-rings deserve praise and they work without any question with the band and allow you to easily manage your aluminum tanks during the dive. The butt plate with its three-section rings proved its superiority over the one-piece. Attaching the equipment is carried out smoothly, there is no risk of anything sticking out that shouldn't and, most importantly, there is no risk of the carabiners jamming, which happens especially when diving with steel tanks. I had a little more fun with the lower dump valve but, as always, it is a matter of practice in uncovering it. Positioning the central dump valve in the lower part of the side mount seems to be the best solution because there are tanks at the side and equipment for the butt-plate, etc. which significantly hinders locating the ball and the dump valve is outside. Here, of course, the task is easier because there is the previously mentioned extra dump valve on the back of the neck.

Under the water when attempting to attach the "long" regulator, I found that the d-rings on the shoulder straps were too low, but it is a question of adjustment.

Another pleasant surprise was the position on the surface. I did not feel the effect of lying on the face, which is often the domain of a typical side mount harness. The only thing that could be criticized was that with a full BCD the compression effect occurs because the BCD is attached to the waist belt. On the other hand, buoyancy jackets also have this effect and the need to fully pump the BCD is rather occasional :-). Anyway, after diving and visual inspection, it turned out that you can easily convert the harness in order to compensate for this effect, e.g. you disentangle the belt while fixing the BCD to rubber bands with the carabiners to the d-rings.

To sum up, under the water everything is as it should be; nothing bothers you; everything is where it should be.

SUMMING UP...

The harness with the BCD is a well-arranged structure, easy on the eye, where nothing has been left to chance. It works fine in the water giving the impression of unity with the diver. The technical solutions to the type of dump valve on the back of the neck, the divided rings on the butt plate and the fully adjustable shoulder belts deserve to be called a thoughtful design that meets the requirements of everyone:

- instructors and centres will appreciate the ease of adjusting the harness for each customer
- people who value the comfort of donning the harness or diving in different suits will also appreciate the adjustable harness
- the BCD, with the possibility of removing the upper dump valve, can develop with the diver and the environment in which he/she dives.
- a compact one-piece design
- the construction imposes the correct position under water
- spacious weight pockets
- the pockets are rather set low - convenient for aluminum cylinders
- good position on the surface
- split ring on the butt plate (sensational)
- movable d-rings on the belt
- with the addition of the weight pockets which I got there is no problem of taking 26-30 kg without the need of putting the weights on the belt
- a good fit

DOMINIK "KESSER" KESSELRING

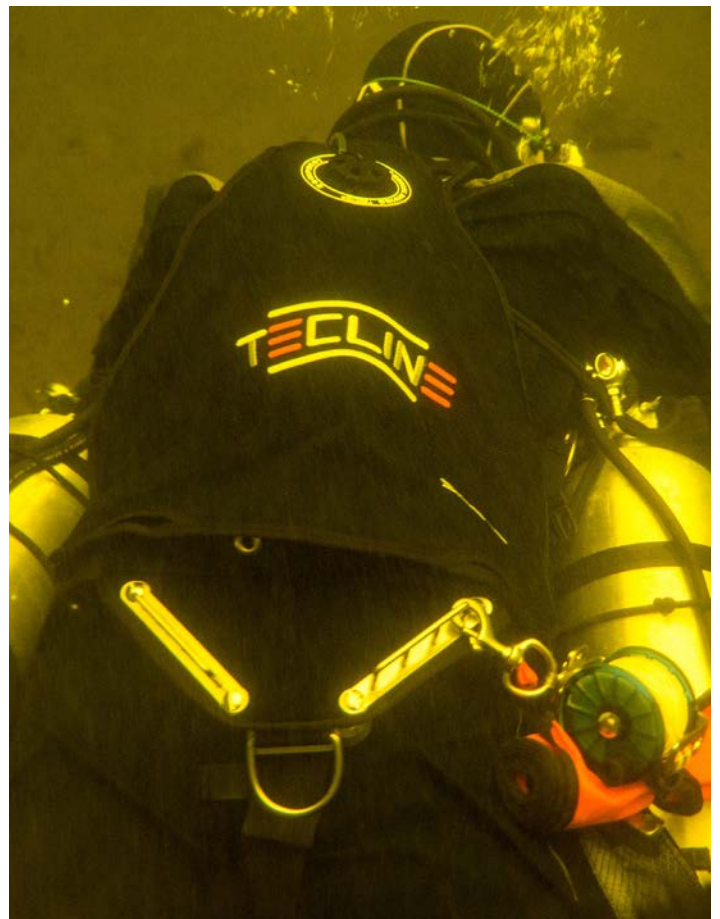



TECLINE

Find us on 

UL. LUBIESZYŃSKA 2
72-006 MIERZYN
POLAND

SCUBATECH@SCUBATECH.PL
TEL/FAX +48 91 453 00 17

THE PERFECT CONFIGURATION

WWW.TECLINE.COM.PL